



## PLT-99301

# 1200Amp 12V Lithium Power Supply and Jump Starter



### Features:

- High capacity 18000mAh lithium battery
- Output: 1200 Peak Amps / 600 Cranking Amps
- Starts vehicles with up to 9.6L gas and 7.0L diesel engines
- Intelligent jumper cables have overload and short circuit protection
- UL approved battery
- Includes the industries best battery safety management system
- Quick charge input allows 40% faster battery recharging
- Built-in (3) mode LED flashlight function
- 19V output to charge laptops (Adapter not included)
- 12V output to charge DC devices
- Working temperature range: 14° F to 140° F

### Includes:

- (1) AC wall charger
- (1) USB to micro data cable
- (1) Intelligent jumper cable set
- Convenient carrying case



**WARNING:** Read all instructions before operating this product. Failure to follow all instructions listed below may result in electric shock, fire and/or serious injury.

## SAVE THESE INSTRUCTIONS

### IMPORTANT SAFETY INSTRUCTIONS

- Avoid dangerous environments. Don't use appliances in damp or wet locations. Don't use this product in the rain or damp locations.
- Keep children away. All electrical products are hazardous and can cause injury
- Product Storage. When not in use, this product should be stored indoors in a dry and secure location. Do not let children have access to this product.
- Product use. Do not use this product for any task except that for which it is intended.
- Don't abuse cord. Never carry appliance by cord or pull it to disconnect from receptacle. Keep cord from heat, oil and sharp objects.
- Disconnect the appliance from the power supply when not in use, before servicing, and when changing accessories.
- Use of accessories and attachments. Use the supplied genuine accessories and attachments. Except for USB cables, DO NOT use ANY other cords/cables NOT provided with this product
- **DANGER:** The use of any accessory or attachment not recommended for use with this appliance could be hazardous.
- Use with caution. As with any electrical appliance use with caution in an uninterrupted manner
- Do not operate this appliance near flammable liquids or in gaseous or explosive atmospheres.
- Never submerge this unit or the 120 Volt AC charger in water; do not expose this unit or the 120 Volt AC Charger to rain, snow or use when wet.
- To reduce risk of electric shock, disconnect the unit from any power source before cleaning. Turning off controls without disconnecting will not reduce this risk.

### SPECIFIC SAFETY INSTRUCTIONS FOR LITHIUM-ION BATTERIES

**WARNING:** TO REDUCE THE RISK OF FIRE, ELECTRIC SHOCK, BURST HAZARD, OR INJURY TO PERSONS OR PROPERTY:

Lithium-ion batteries are small, compact and ideal for providing long-lasting power to this unit. However, they must be used and charged properly. Improper use can result in serious injury, fire, or death.

- Lithium-ion batteries can explode in the presence of a source of ignition. Do not use the product in the presence of an open flame.
- Do not place this lithium-ion battery powered unit in fire or apply heat to it.
- Do not subject this lithium-ion battery powered unit to strong impacts or shocks. The battery in this unit contains safety and protection devices which, if damaged, may cause the battery to generate heat, rupture or ignite.
- Do not expose this lithium-ion battery powered unit to water or salt water, or allow the battery to get wet.
- Avoid storing this lithium-ion battery powered unit in the basement, bathroom or other areas of the house that are or may become wet.
- Do not leave this lithium-ion battery powered unit in direct sunlight, or use or store the unit inside cars in hot weather. Doing so may cause the battery to generate heat, rupture, or ignite. Using the battery in this manner may also result in a loss of performance and a shortened life expectancy.
- Never charge this unit near heat or flammable objects.
- **NEVER THROW WATER ON A BURNING LI-ION BATTERY!** If a lithium-ion battery does catch on fire, it will burn even more violently if it comes in contact with water or even moisture in the air. **A fire extinguisher must be used.**

## TRANSPORTATION OF LITHIUM-ION BATTERIES

- Always check all applicable local, national, and international regulations before transporting a unit containing a lithium-ion battery.
- Transporting an end-of-life, damaged, or recalled battery may, in certain cases, be specifically limited or prohibited.

## SPECIFIC SAFETY INSTRUCTIONS FOR JUMP STARTERS

### CAUTION: TO REDUCE THE RISK OF INJURY OR PROPERTY DAMAGE:

- NEVER ATTEMPT TO BOOST OR CHARGE A FROZEN BATTERY.
- Use the PLT-99301 for jump starting lead-acid batteries only. Do not use for charging dry-cell batteries that are commonly used with home appliances. These batteries may burst and cause injury to persons and damage to property.
- Do not operate unit with damaged cord or plug; or if the unit has received a sharp blow, been dropped, or otherwise damaged in any way. Do not disassemble the unit; return it to the manufacturer when service or repair is required. Opening the unit may result in a risk of electric shock or fire, and will void warranty.
- Make sure cord is located so that it will not be stepped on, tripped over or otherwise subjected to damage or stress.
- Do not leave the unit unattended while in use.
- This unit is not for use by children and should only be operated by adults.
- Disconnect adapter by pulling the plug rather than the cord when disconnecting the 120V AC charger.
- Vehicles that have on-board computerized systems may be damaged if vehicle battery is boosted. Before boosting, read the vehicle's owner's manual to confirm that external-starting assistance is suitable.
- This system is designed to be used on vehicles with a 12 volt DC battery system. Do not connect to a 6 volt or 24 volt battery system.
- Excessive engine cranking can damage a vehicle's starter motor. If the engine fails to start after the recommended number of attempts, discontinue boosting procedures and look for other problems that may need to be corrected.

## TECHNICAL SPECIFICATION

<b>Jump Starting Output</b>	12V
<b>Start current</b>	600A
<b>Peak current</b>	1,200A
<b>Output Ports</b>	USB1-5V $\approx$ 2.4A / 9V $\approx$ 2A /12V $\approx$ 1.5A USB2-5V $\approx$ 2.4A / 9V $\approx$ 2A /12V $\approx$ 1.5A DC 5.5mm port- 19V $\approx$ 3.5A DC 5.5mm port- 12V $\approx$ 10A
<b>Input Port</b>	Micro USB 5V $\approx$ 2A / 9V $\approx$ 2A /12V $\approx$ 1.5A
<b>Battery</b>	Lithium polymer 18,000mAh /66.6Wh
<b>Charging time</b>	4 to 4.5 hours
<b>Operating temperature</b>	-10°C to +60°C/14°F to 140°F
<b>Battery box dimension</b>	8.9 x 3.6 x 1.2 inch

## COMPONENTS AND CONTROLS

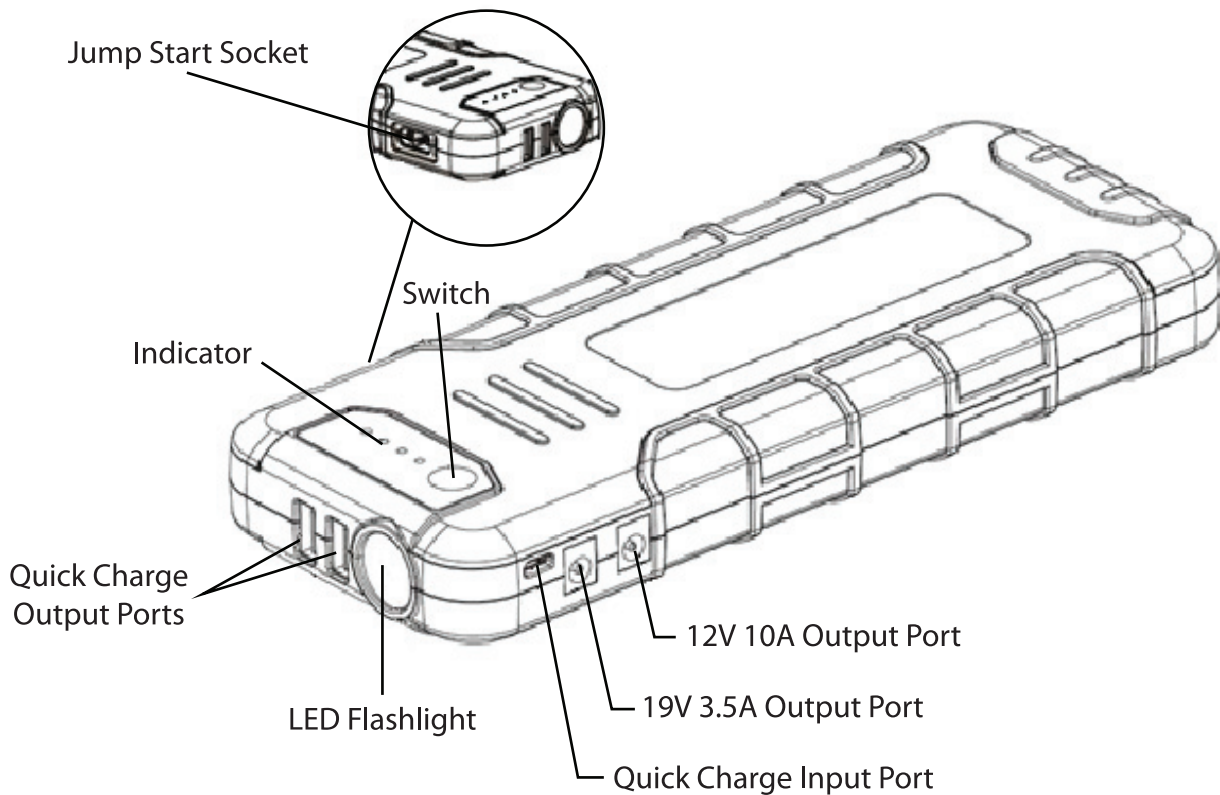

## BATTERY LEVEL INDICATOR

The PLT-99301 battery box has four indicator lights to determine the amount of power in the unit.

- Press Main Power Button to activate the lights.
- The blue indicator lights will flash one by one when the unit is charging. A solid light indicates a complete level of charge. For example, when 2 lights are illuminated and a third is blinking, that means the unit is between 50-70% charged. Once the third light stops blinking the unit is 75% Charged.
- When all the indicator lights are lit, the charging is complete and the unit will automatically turn out.

## CHARGING THE BATTERY BOX

The PLT-99301 is delivered in a partially charged state – you must fully charge it before using it for the first time. When stored at room temperature with a full charge, Li-ion batteries will begin to discharge from the time they are manufactured, even when unused. Deep discharges also decrease their capacity.

Battery life can be extended by the following:

- Charge battery to full capacity before storage.
- Store this unit at temperatures between 5° C and 20° C (41° F and 68° F).
- Never discharge the battery fully.
- Charge after each use.
- Always charge at least once every 3-6 months if not in frequent use to prevent over-discharge.

**⚠ WARNING:** Use of an attachment not recommended or sold by the manufacturer may result in a risk of damage to the unit or injury to personnel.

**⚠ WARNING:** When using the wall charger or power extension cord, pull on the plug and never on the wire when disconnecting.

**⚠ WARNING:** Do not recharge the PLT-99301 with a damaged wall charger or power extension cord. Replace them immediately.

## 120-Volt AC Charging

- (1) Connect 120VAC wall charger adaptor (PRT99301-02) to USB cable (PRT99301-04).
- (2) Insert PRT99301-04 into the input port of the battery box.
- (3) Insert the plug end of PRT99301-02 into a (powered) standard North American 120 volt 60Hz outlet.

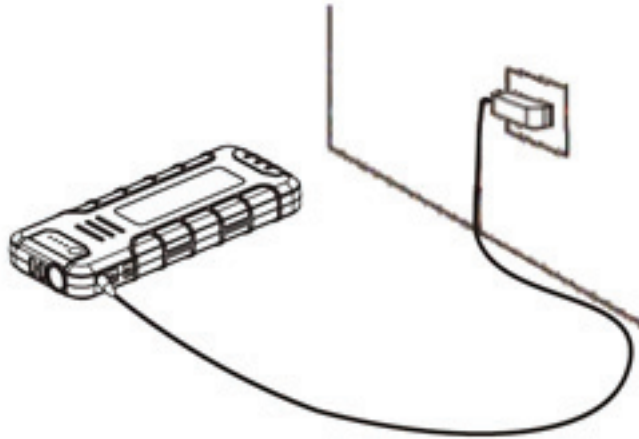

## 12-Volt DC Charging

- (1) Insert micro USB male plug of the PRT99301-04 into the input Port on the side of the PLT-99301 battery box.
- (2) Insert standard USB male plug of the PRT99301-04 to DC power source such as a power bank, computer, laptop, onboard 12V cigarette socket, etc

**NOTE:** Some vehicles require that the ignition be switched to the accessory outlet position in order to power the accessory outlet. Do not leave the unit unattended when charging using this method.

**NOTE:** The indicators on PLT-99301 battery box will change from empty to solid (left to right) repeatedly to indicate the unit is charging. All indicators will go off once internal battery is fully charged.

## JUMP START A VEHICLE

**Important:** Always properly service and maintain your vehicle's primary lead acid battery, as detailed in your Owner's Manual. It is also recommended that you replace your primary battery when the manufacturer's warranty period expires; the date is stamped on the top of the battery.

- ⚠ WARNING: NEVER press "BOOST" button when RED LIGHT is illuminated.**
- ⚠ WARNING: The cable is for jump starting only through the Jump Start Socket of the PLT-99301 battery box.**

1. Press Main Power Button, make sure at least three solid indicators are illuminated.
2. Remove any USB or charging devices connected to the battery box.
3. Put your vehicle in PARK and engage the emergency brake.
4. Make sure the vehicle battery terminals, jumper clamps are free of rust or corrosion.
5. Turn off the vehicle ignition switch and all accessories (lights, radio, climate control, etc)
6. Ensure key is in "OFF" position in the ignition. For a keyless car (Push-to-start), make sure the car is completely "OFF" before jump start.
7. Connect the **RED** jumper clamp to the positive (+) terminal on the car battery.
8. Connect the **BLACK** jumper clamp to the negative (-) terminal on the car battery.

9. Plug the blue plug of jumper cable into Jump Start Socket on the front panel of the jump starter.
  - If **GREEN LED** lights: This indicates a proper battery connection is made. Crank the engine.
  - Note:** If the vehicle does not start within three continuous attempts, turn the key off and wait a minute before attempting to start the vehicle again.
  - If the **RED LED** lights and Buzzer sounds: This indicates a reverse connection. Disconnect from vehicle immediately and properly reconnect to jumper clamps to battery.
  - If **GREEN LED** blinking: This indicates vehicle's battery is too low. Press the "BOOST" button on black control box. Once GREEN indicator is on, crank the engine within 30 seconds.
  - If **No LED** is lit: This indicates a damaged battery or no battery. If you check that all connections are correct (including unit cable connection), you can circumvent this protection by depressing the round Override Button on the clamp box. The **GREEN LED** should light. Crank the engine within 30 seconds.
10. When the vehicle is started, disconnect the negative (-) battery clamp from the vehicle frame.
11. Disconnect the Positive (+) clamp.
12. Disconnect output cables/clamps and properly store them for the next use.

### CHARGING USB DEVICES

The PLT-99301 battery box comes with two Quick Charge 3.0 USB output ports. This technology ensures the fastest charging efficiency, 4x faster than conventional charger. Backward compatible with QC 1.0 and 2.0. SmartID Technology: Recognizes the electronic device and maximizes charging efficiency. They can be used to power or recharge a wide variety of small electronic devices.

1. Connect PRT99301-04 or your device's charging cable to the device.
2. Connect the USB end of the charging cable into the USB port.
3. Press the Main Power Button on the front of the unit to activate USB charging.

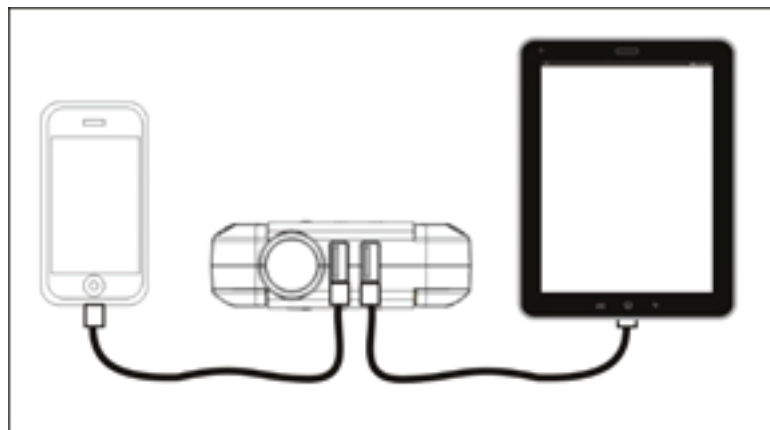

### CHARGING A 19 VOLT LAPTOP

**NOTE:** To charge a 19V laptop, laptop charging tips and extension cable are needed. (Not included)

1. Plug the extension cable to 19V 3.5A output port.
2. Select appropriate connector for your laptop and connect it to the extension cable and your laptop.
3. Press the Main Power button to charge/power supply.

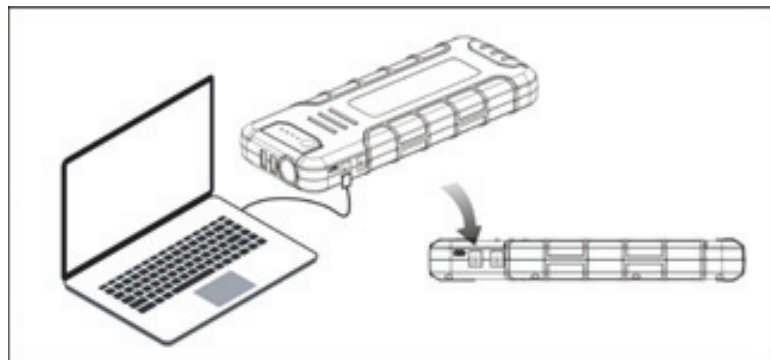

### RUNNING/CHARGING 12V

12V,10A DC port recharges many 12V DC products (12V DC Power Plug Adapter is needed). Ideally for camping, off-road adventure, or mobile office. To charge a 12V device, you can charge using a 12V DC Vehicle Power Plug with your device adapter. (Power Plug and adapter not included).



(adapters shown for illustration purpose - not included)

1. Plug your power plug adapter into the 12V 10A output port on the battery box. Make sure that the device to be powered is turned off and its power requirement **DOES NOT** exceed 10A.
2. Connect your devices.
3. Press Main Power Button and turn on the appliance.



(adapter shown for illustration purpose - not included)

## USE AS A FLASHLIGHT

To turn on the LED Flashlight, press and hold the Status/Power Button for three seconds. Each successive push of the button will change the light pattern from solid to strobe to SOS to off.

## TROUBLESHOOTING

### Unit will not charge

- Make sure the Main Power Button has been pressed to turn the unit on.
- Check connection to the 120 Volt AC Charging Port.
- Check connection to AC or DC power source.
- Confirm there is a functioning AC or DC current.

### Unit will not boost

- Make sure the unit has a full charge. Recharge unit if necessary.

### Unit will not operate

- The Jump starter's internal battery may be completely discharged. Charge the unit following the directions.
- The vehicle battery may be damaged, manufacturer suggests that you have your vehicle's battery tested by a qualified battery service technician.
- If the unit does not operate after recharging as directed and you have determined that the vehicle battery you are attempting to boost is not damaged or defective, contact the seller.

### No response when pressing the Main Power Button.

- Low voltage protection or overload protection is tripped. Connect the booster to power source by the wall charger to reset the unit.

## CARE AND MAINTENANCE

All batteries lose energy from self-discharge over time and more rapidly at higher temperatures. When the unit is not in use, we recommend that the battery is charged at least every 3-6 months. Never submerge the unit in water. If the unit gets dirty, gently clean the outer surfaces of the unit with a soft cloth moistened with a mild solution of water and detergent.

## BATTERY REPLACEMENT/DISPOSAL

The battery should last the service life of the unit. Contact the manufacturer for any information you may need. This unit contains a lithium-ion battery, which must be disposed of properly. Recycling is required, contact your local authority for information. Failure to comply with local, state and federal regulations can result in fines, or imprisonment. Contact your local waste management authority to dispose of this product.

### **WARNING:**

- Do not dispose of the battery in fire as this may result in an explosion.
- Do not expose battery to fire or intense heat as it may explode.

## PLT-99301



ITEM#	ORDERING PART#	PART DESCRIPTION
	PLT99301	BATTERY BOX
01	PRT99301-01	INTELLIGENT JUMPER CABLES
02	PRT99301-02	120V AC WALL CHARGER ADAPTER
04	PRT99301-04	USB TO MICRO USB DATA CABLE
07	PRT99301-07	CARRYING CASE



**PLATINUM  
TECH™**

## **WARRANTY**

### **1 YEAR LIMITED WARRANTY**

**THIS WARRANTY AND CONFIRMED RECEIPT(S) SHOULD BE RETAINED BY THE CUSTOMER AT ALL TIMES**

PURCHASED FROM: \_\_\_\_\_

DATE PURCHASED: \_\_\_\_\_

INVOICE/RECEIPT NUMBER: \_\_\_\_\_

Your PLT-99301 is warranted for a period of 12 months from the original purchase date. Accessories such as charger, jumper cable (clamps) and USB cable are warranted against defects for a period of 90 days.

For a period of one (1) year from your purchase date, ATD Tools Inc. will repair or replace (at its option) without charge, your ATD product if it was purchased new and the product has failed due to a defect in material or workmanship which you experienced during normal use of the product. This limited warranty is your exclusive remedy.

To access the benefits of this warranty, contact your supplier, or point of sale directly. You may be advised to return the product under warranty, freight prepaid, to your supplier for warranty determination.

If this ATD product is altered, abused, misused, modified, or undergoes service by an unauthorized technician, your warranty will be void. We are not responsible for damage to ornamental designs you place on this ATD product and such ornamentation should not cover any warnings or instructions or they may void the warranty. This warranty does not cover scratches, superficial dents, and other abrasions to the paint finish that occur under normal use. It also does not cover normal wear items such as but not limited to brushes, batteries, drill bits, drill chucks, pads or blades.

Subject to the law in your state:

- (1) Your sole and exclusive remedy is repair or replacement of the defective product as described above.
- (2) ATD is not liable for any incidental damages, including but not limited to, lost profits and unforeseeable consequences.
- (3) The repair and replacement of this product under the express limited warranty described above is your exclusive remedy and is provided in lieu of all other warranties, express or implied. All other warranties, including implied warranties and warranties of merchantability or fitness for a particular purpose are disclaimed and, if disclaimer is prohibited, these warranties are limited to one year from your date of purchase of this product.

Some states' laws do not allow limited durations on certain implied warranties and some states' laws do not allow limitations on incidental or consequential damages. You should consult the law in your state to determine how your rights may vary.

[Affix receipt or invoice here for safe keeping]